

# Orca Auto 1300



## Compact, powerful and automatic

Submersible bilge pump with large footprint to ensure maximum surface area exposure to bilge water - no separate bilge switch required!

### Integrated Electronics

Fully potted IC built in intelligent control. Microprocessor electronics sealed for protection against water ingress

### Fully Protected

Robust housing made from fuel resistant ABS



### Easy Install

25mm (1")  
28mm (1 1/8")  
stepped  
connection  
ports to suit  
your installation

### Efficiency

Large surface area ensures maximum area exposed to bilge water

Product code: see table

## Features and Benefits

### WHY ORCA AUTO 1300?

Introducing Whale's latest addition to our intelligent automatic electric bilge pump range

- High performance - 1300 US gals/hr flow rate
- Simple to install - built in automatic sensor
- No separate bilge switch is required
- Long battery life - low amp draw
- Neat fit in compact bilge areas
- ABS fuel - resistant housing
- Efficient - large filter ensures maximum surface area exposed to bilge water

### 1 Year Warranty

### Awards and Accreditations

- Conforms to ISO 8849
- CE certified

### COMPLETE YOUR SYSTEM

Bilge system accessories including non -return valves, elbows and y pieces. Page 48 - 51

### YOU MAY ALSO LIKE

Supersub Smart  
– Narrow low profile automatic electric bilge pumps – page 20

Bilge IC  
– The remote mounted pre-assembled bilge pump kit with Intelligent Control built in – page 24

## Product Information



### Model Specifications

Product Code	NEW Whale Orca Auto 1300	
	BE1482	BE1484
Nominal Voltage	12 V d.c.	24 V d.c.
Open Flow Rate @13.6 V d.c.	1300 US GPH (82 l/min)	1300 US GPH (82 l/min)
Flow rate at 1m (3ft) head	1100 GPH (65 l/min)	1100 GPH (65 l/min)
Current Draw	5 Amps	2.5 Amps
Recommended Automotive Fuse Size	7.5 Amp	5 Amp
Weight	0.9 kg (2lbs)	
Hose Connection	Stepped ports 25mm (1") and 28mm (1 1/8")	
Wire Size	16 AWG x 1m (3ft)	
Maximum Discharge Head	4.5m (14.8ft)	
Overall Height	129mm (5.1")	
Overall Width	168mm (6.6")	
Overall depth	121mm (4.8")	
Materials	Pump Body- ABS, Seals: Nitrile®, Impeller: Acetal	

Note: For wiring advice on your installation, please contact Whale.  
These specifications are retail items only. For details of our bulk pack range for boat builders and wholesalers - contact Whale Support

Registered design 000672216

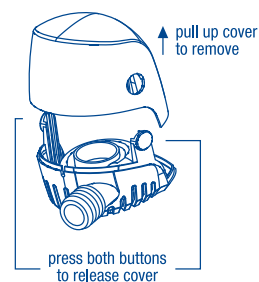

Easy maintenance

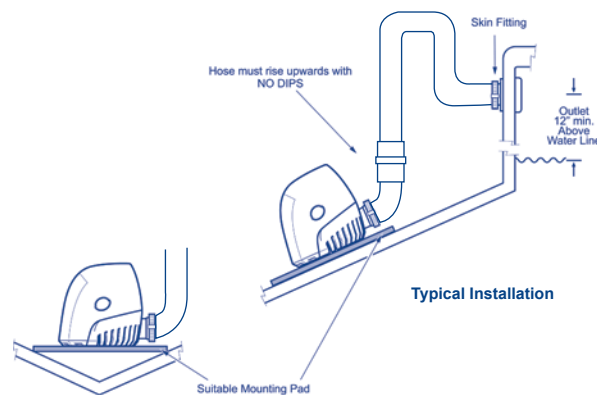

Typical Installation