

## Glass Reinforced Seacock Kits

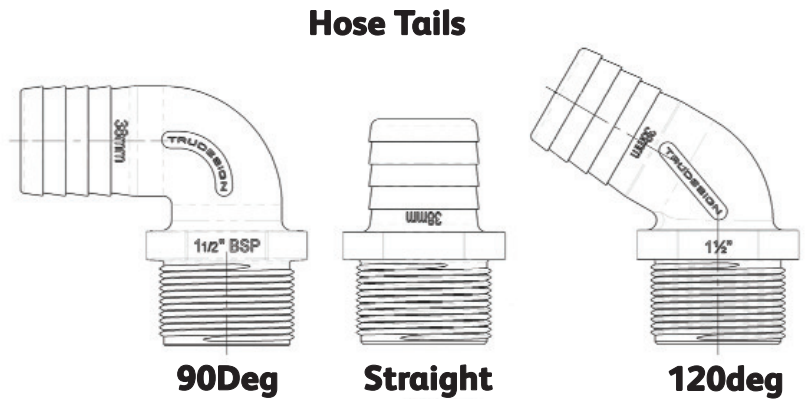

**When fitting a seacock kit. please consult a marine engineer for recommendation on installation procedures**

Seacock Kit Part Numbers		Straight	120 deg	90 deg
BSP Thread / Hose Size	¾" (19mm)	<b>03410</b>	/	<b>03415</b>
	1" (25mm)	<b>03411</b>	<b>03420</b>	<b>03416</b>
	1¼" (32mm)	<b>03412</b>	/	<b>03417</b>
	1½" (38mm)	<b>03413</b>	<b>03421</b>	<b>03418</b>
	2" (50mm)	<b>03414</b>	<b>03422</b>	<b>03419</b>



### Ball Valve

**Recommended Sealant on threads of ball valve**

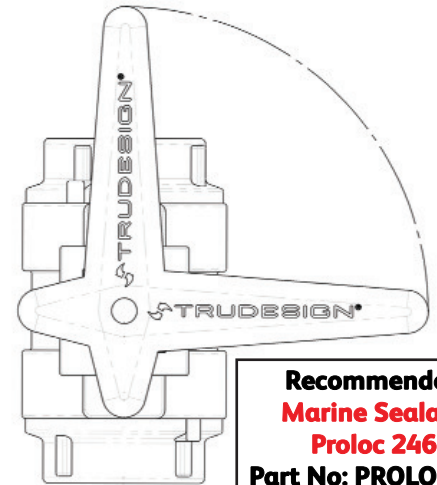



**Recommended Marine Sealant Proloc 246 Part No: PROLOC246**

### LeeSan Tru Design Seacock Kits Consists of:

- 1 No. Through hull skin fitting**
- 1 No. Bureau Veritas approved ball valve**
- 1 No. Hosetail**

### Load Bearing Collars

90856	90587
¾" (19mm), 1" (25mm)	1¼" (32mm), 1½" (38mm)
	

### Through hull skin fittings

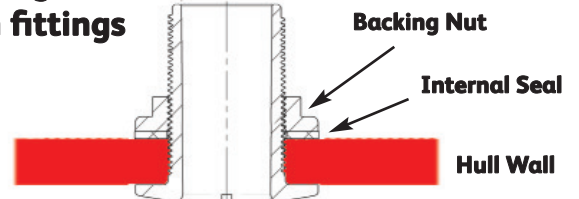

	Connector Male / Female 90 deg				
	¾" (19mm)	1" (25mm)	1¼" (32mm)	1½" (38mm)	2" (50mm)
	<b>90777</b>	<b>90779</b>	<b>90632</b>	<b>90630</b>	<b>90628</b>

## Glass Reinforced Seacock Kits

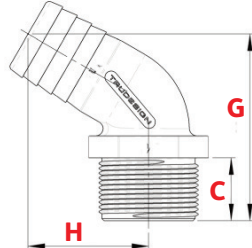
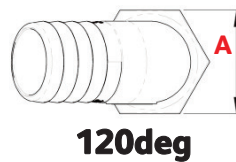
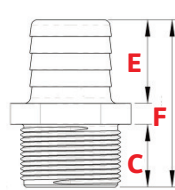
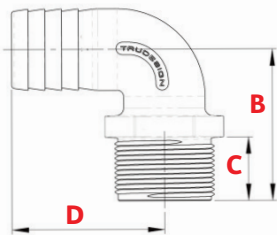
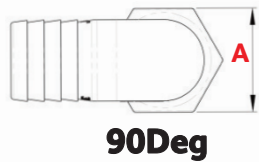

BSP Thread Hose Sizes	¾" 19mm	1" 25mm	1¼" 32mm	1½" 38mm	2" 50mm
<b>A</b>	30	35	44	50	62
<b>B</b>	57	66	70	73	75
<b>C</b>	24	30	30	30	30
<b>D</b>	52	65	71	73	73
<b>E</b>	31	40	40	40	50
<b>F</b>	63	80	80	80	93
<b>G</b>		89		89	91
<b>H</b>		58		58	61

BSP Thread Hose Sizes	¾" 19mm	1" 25mm	1¼" 32mm	1½" 38mm	2" 50mm
<b>I</b>	125	125	145	145	155
<b>J</b>	93	93	108	108	108
<b>K</b>	87	87	102	102	125
<b>L</b>	63	63	75	75	96
<b>M</b>	103	103	122	122	141
<b>N</b>	144	144	169	169	178
<b>P</b>	60	60	72	72	95
<b>Q (Ø ID)</b>	19	19	32	32	52

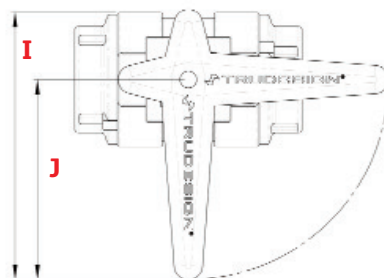

### Ball Valve Spanners

Part No:	Spanner fits ball valves
<b>90477</b>	¾" 19mm, 1" 25mm
<b>90478</b>	1¼" 32mm, 1½" 38mm
<b>90479</b>	2" 50mm

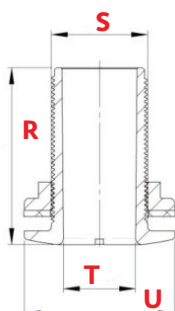
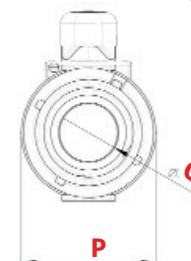
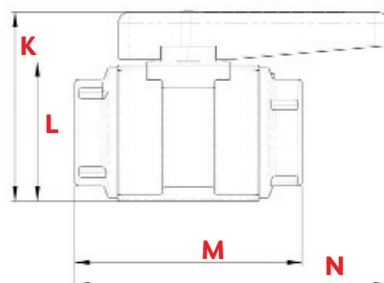

BSP Thread Hose Sizes	¾" 19mm	1" 25mm	1¼" 32mm	1½" 38mm	2" 50mm
<b>R</b>	70	70	88	88	100
<b>ØS</b>	27	33	42	48	60
<b>ØT</b>	17	23	30	36	48
<b>ØU</b>	41	53	66	75	93

### Flow diameter & hull thickness

BSP Thread Hose Sizes	Minimum I.D	Maximum Hull Thickness
<b>¾" 19mm</b>	17	28
<b>1" 25mm</b>	23	28
<b>1¼" 32mm</b>	41	30
<b>1½" 38mm</b>	36	30
<b>2" 50mm</b>	48	40

**All dimensions in mm.  
All dimensions nominal.**